

## 12V28Ah @ 20HR

### Rekoser AGM Battery for General Purpose

AGM Battery. Rekoser stationary series, general use, has been specially designed to optimize its life and quality, minimizing maintenance and maximizing self discharge of their properties for longer storage. RKE series is ideal for security and alarm systems, UPS systems, emergency light systems and other small backup applications.



#### Complied standards

- IEC 60896-21/22
- JIS C8704
- GB/T19639

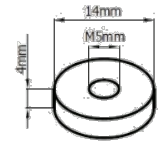
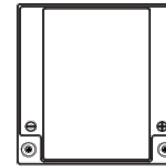

#### SPECIFICATIONS

Nominal Voltage	12V			
Capacity (25°C)	28Ah @ 20HR			
Internal Resistance	Fully Charged 10 m Ω			
Self Discharge	3% of capacity declined per month at 25°C			
Cell number	6 cells			
Capacity Affected by Temperature	102% (40°C)	100% (25°C)	85% (0°C)	65% (-15°C)
Charge Voltage (25°C)	Cycle - 14.6-14.8V (-30mV/C), max. Current 2.1A		Float - 13.6-13.8V (-20mV/C)	
Max. Charge Current	8.4A			
Max. Discharge Current	330A			

#### DIMENSIONS AND WEIGHT

Dimensions (mm)	165x125x175(175)
Weight (kgs)	8.6

#### CONSTRUCTION

Component	Raw Material
Positive	Lead dioxide
Negative	Lead
Container	ABS (Flame Retardant Optional)
Cover	ABS (Flame Retardant Optional)
Sealant	Epoxy Resin
Safety Valve	Rubber
Terminal	Copper
Separator	Fibre Glass
Electrolyte	Sulphuric acid

#### GRAPHICS

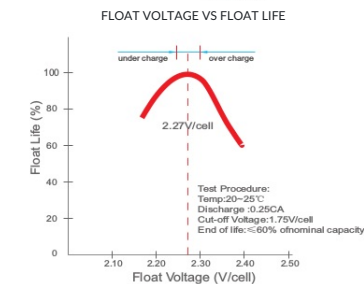
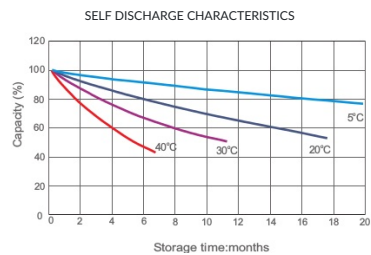
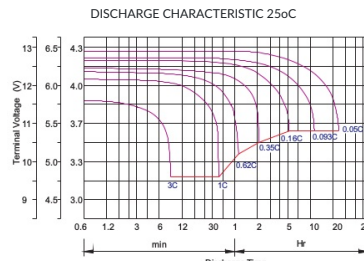
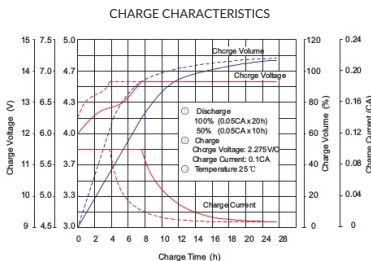

#### CONSTANT DISCHARGE RATINGS (A, W) AT 25°C

F.V / Time	5MIN	10MIN	15MIN	30MIN	1HR	3HR	5HR	10HR	20HR									
11.10 V	69.9A	132W	54.7A	104W	46.4A	88.6W	28.5A	54.9W	17.0A	33.0W	7.36A	14.3W	4.74A	9.39W	2.61A	5.22W	1.33A	2.68W
10.80 V	79.0A	146W	58.1A	109W	47.6A	90.0W	29.1A	55.4W	17.2A	33.1W	7.45A	14.4W	4.79A	9.4W	2.65A	5.26W	1.37A	2.74W
10.50 V	88.2A	161W	61.5A	114W	48.7A	91.3W	29.6A	56.0W	17.6A	33.5W	7.57A	14.5W	4.84A	9.43W	2.68A	5.28W	1.4A	2.78W
10.20 V	96.7A	175W	64.3A	118W	50.0A	92.7W	30.3A	56.8W	17.9A	33.8W	7.65A	14.6W	4.91A	9.49W	2.71A	5.3W	1.43A	2.82W
10.02 V	104A	186W	67.2A	122W	51.3A	94.2W	30.9A	57.3W	18.2A	34.1W	7.71A	14.7W	4.98A	9.53W	2.74A	5.32W	1.46A	2.85W
9.60 V	112A	198W	69.6A	125W	53.1A	96.9W	31.6A	58.4W	18.4A	34.3W	7.79A	14.8W	5.03A	9.58W	2.78A	5.36W	1.48A	2.88W