

## STANDARDS



ISO9001



ISO14001



## Complied standards

- IEC 60896-11
- DIN40736
- IEC61427
- Eurobat guide, long life
- BS6290 part 4
- UL1989

## IMAGE



## TERMINAL TYPE

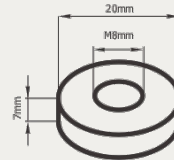
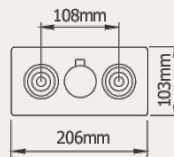

## SPECIFICATIONS

<b>Capacity (25°C)</b>	<b>200Ah @ 10HR</b>			
<b>Internal Resistance</b>	<b>Approx. 0.35mOhm (fully charged @ 20°C)</b>			
<b>Self Discharge</b>	<b>3% of capacity declined per month at 20°C</b>			
<b>Capacity Affected by Temperature</b>	<b>102% (40°C)</b>	<b>100% (25°C)</b>	<b>85% (0°C)</b>	<b>65% (-15°C)</b>
<b>Charge Voltage (25°C)</b>	<b>Cycle - 2.35-2.40V (-5mV/°C/cell)</b>		<b>Float - 2.21-2.25V (-3mV/°C/cell)</b>	
<b>Max. Charge Current</b>	<b>40A</b>			
<b>Max. Discharge Current</b>	<b>1250A</b>			

## DIMENSIONS

<b>Length</b>	<b>Width</b>
103mm	206mm
<b>Height</b>	<b>Total Height</b>
354mm	409mm
<b>Approx. Weight</b>	<b>w/o electrolyte: 13Kg</b>

## CONSTRUCTION

<b>Component</b>	<b>Raw Material</b>	<b>Sealant</b>	Epoxy Resin
<b>Positive</b>	Lead dioxide	<b>Safety Valve</b>	Rubber
<b>Negative</b>	Lead	<b>Terminal</b>	Copper
<b>Container</b>	SAN	<b>Separator</b>	Fibre Glass
<b>Cover</b>	ABS (Flame Retardant Optional)	<b>Electrolyte</b>	Sulphuric acid

## CHARGE CHARACTERISTICS

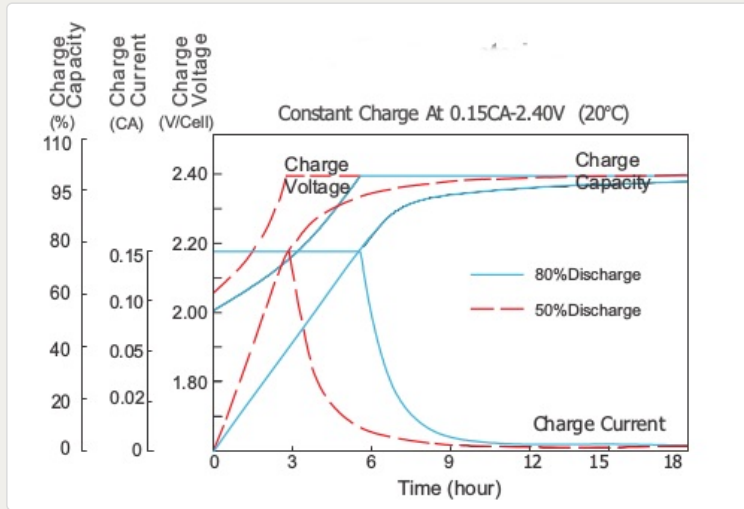

## DISCHARGE CHARACTERISTIC 25°C

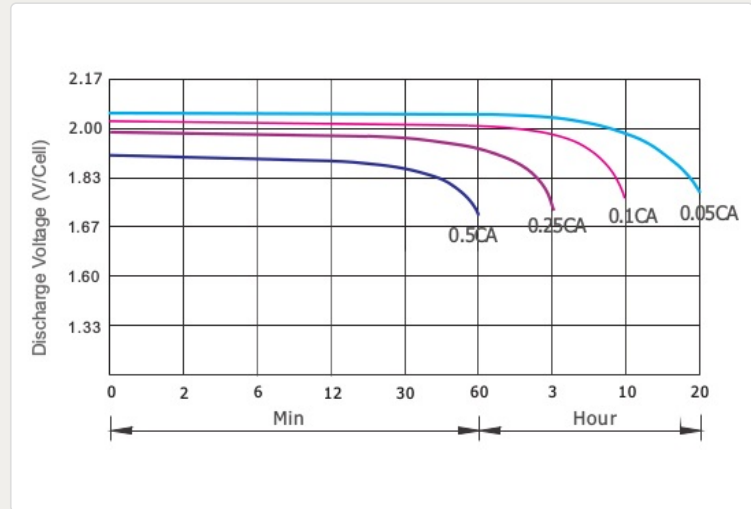

## SELF DISCHARGE CHARACTERISTICS

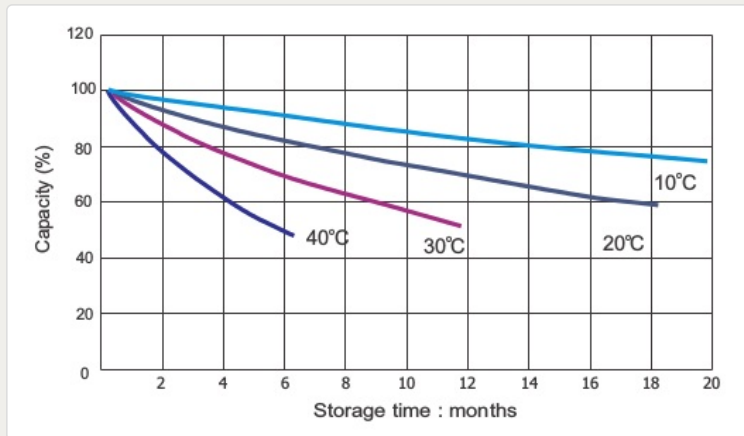

## FLOAT VOLTAGE VS FLOAT LIFE

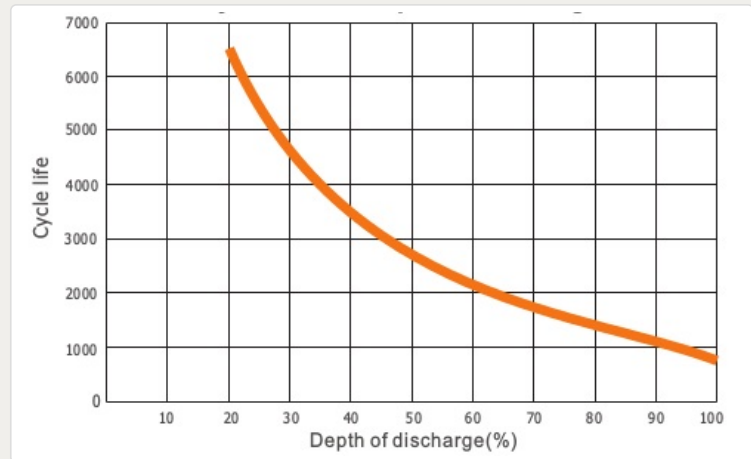

## CYCLE DISCHARGE VOLTAGE CURVE (Test standard BS EN 61427:2005)

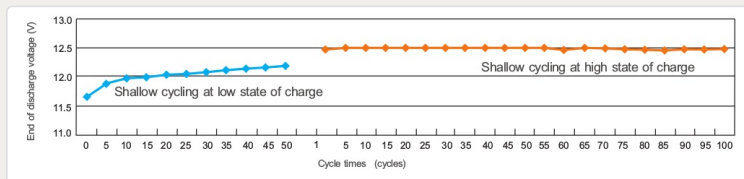

## CONSTANT DISCHARGE RATINGS

F.V / Time	5MIN	10MIN	15MIN	30MIN	1HR	3HR	5HR	10HR	20HR	100HR										
1.90 V	79.8	155	72.6	141	66.0	126	64.6	122	59.8	115	37.8	82.2	27.8	59.6	18.2	37.6	10.0	20.2	2.54	5.5
1.85 V	86.2	167	82.6	160	81.2	156	80.8	152	68.0	131	41.8	86.0	32.6	66.2	19.0	40.8	10.5	22.0	2.7	5.73
1.80 V	138	267	132	256	129	220	111	203	87.4	171	51.2	109	34.6	75.6	20.0	44.0	11.0	22.8	2.8	5.88
1.75 V	165	320	158	307	154	225	127	205	97.4	173	53.0	116	35.6	79.0	20.6	45.8	11.6	23.4	2.86	5.93

CONSTANT CURRENT DISCHARGE RATINGS - AMPERES AT 25°C

CONSTANT POWER DISCHARGE RATINGS - WATTS AT 25°C