

## 2V350Ah @ 10HR

### Rekoser OPzS Battery

Rekoser OPzS battery. The OPzS series is a traditional tubular plate flooded battery which offers 20+ years design life according to the standard IEC60896-11. With a new design and technical improvement, it offers maximum efficiency and reliability for the widest variety of applications. This series is highly suited for all standby power applications that require the highest levels of reliability and security.



#### Complied standards

- IEC 60896-11
- DIN40736
- IEC61427
- Eurobat guide, long lif
- BS6290 part 4

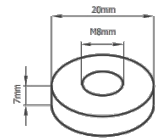
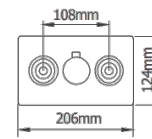

TERMINAL DIMENSION

#### SPECIFICATIONS

Nominal Voltage	2V			
Capacity (25°C)	350Ah @ 10HR	386Ah @ 20HR		
Internal Resistance	Approx. 0.32mOhm (fully charged @ 20°C)			
Self Discharge	3% of capacity declined per month at 20°C			
Cell number	1 cells			
Capacity Affected by Temperature	102% (40°C)	100% (25°C)	85% (0°C)	65% (-15°C)
Charge Voltage (25°C)	Cycle - 2.35-2.40V (-5mV/°C/cell)		Float - 2.21-2.25V (-3mV/°C/cell)	
Max. Charge Current	70A			
Max. Discharge Current	1500A			

#### DIMENSIONS AND WEIGHT

Dimensions (mm)	124x206x470(525)
Weight (kgs)	w/o electrolyte: 20 w/ electrolyte: 27

#### CONSTRUCTION

Component	Raw Material
Positive	Lead dioxide
Negative	Lead
Container	SAN
Cover	ABS (Flame Retardant Optional)
Sealant	Epoxy Resin
Safety Valve	Rubber
Terminal	Copper
Separator	Fibre Glass
Electrolyte	Sulphuric acid

#### GRAPHICS

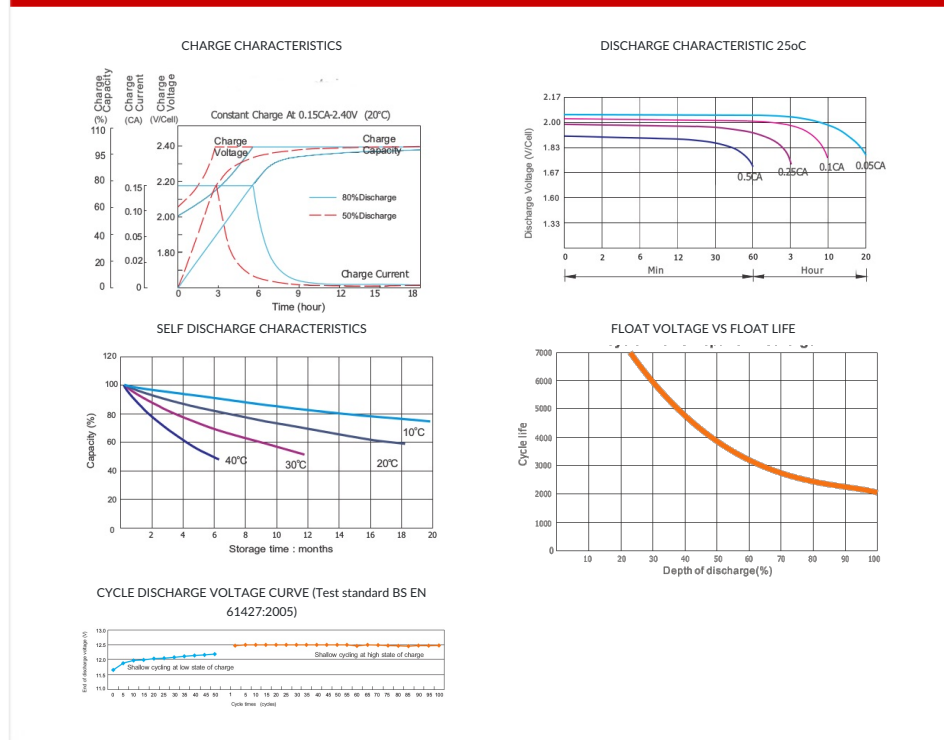

#### CONSTANT DISCHARGE RATINGS (A, W) AT 25°C

F.V / Time	5MIN	10MIN	30MIN	1HR	3HR	5HR	10HR	20HR	100HR
1.90 V	140A 271W	127A 246W	113A 214W	105A 201W	66.2A 144W	48.7A 104W	31.9A 65.8W	17.5A 35.3W	4.45A 9.63W
1.85 V	151A 293W	145A 281W	141A 266W	119A 229W	73.2A 151W	57.1A 116W	33.3A 71.4W	18.3A 38.4W	4.73A 10.0W
1.80 V	241A 467W	231A 448W	195A 356W	153A 300W	89.6A 191W	60.6A 132W	35.0A 77.0W	19.3A 39.9W	4.9A 10.3W
1.75 V	289A 561W	277A 538W	223A 358W	170A 302W	92.8A 203W	62.3A 138W	36.1A 80.2W	20.2A 40.9W	5.01A 10.4W